

and plastic sleeve should be in the middle of the vertical slot (in lower part of the cradle). If it is not, loosen the top clamp knobs and the hex nuts which position the bottom cradle on the threaded rods, then adjust them upward lifting the stack until the shoulder bolt with plastic sleeve is centered. Retighten the fasteners (hex nuts and knobs).

When operating correctly, the movement upward and downward of the rod springs should be approximately equal. Test for this by hand turning the pulley one revolution and note the spring deflections at the top and bottom of the travel. If they are not equal repeat the adjustment until they are approximately equal. When they are approximately equal, normal operation can begin.

Maintenance

- Oil the main pulley driven shaft weekly.
- Maintain the nuts on the springs tight.
- Check for properly adjusted sieve stack.
- Periodically check all fasteners for tightness.

CAUTION: Keep hands, clothing and other objects away from moving parts when the machine is in operation.

Drawing

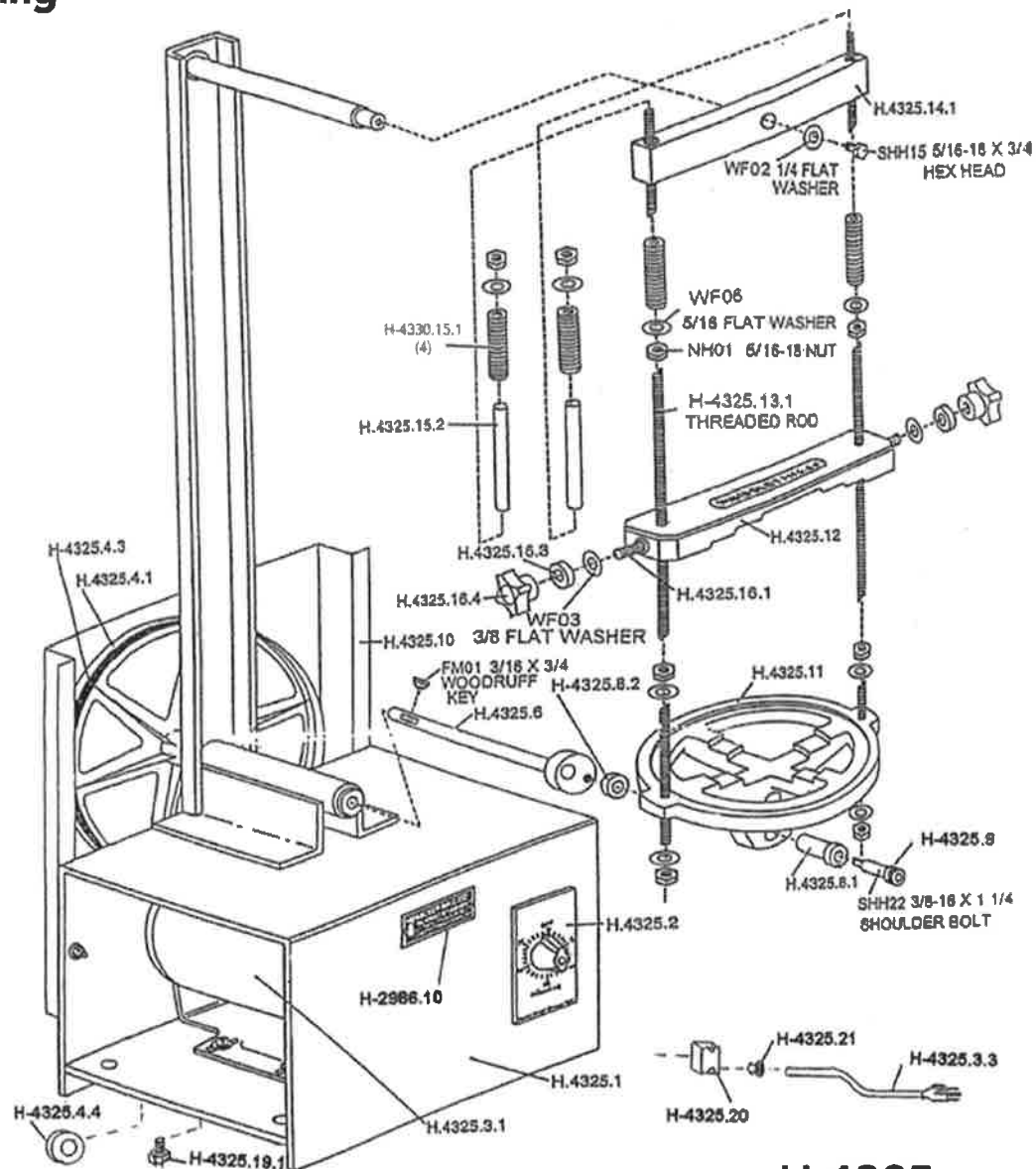

H-4325

rev. 01.12.04